

May 2019

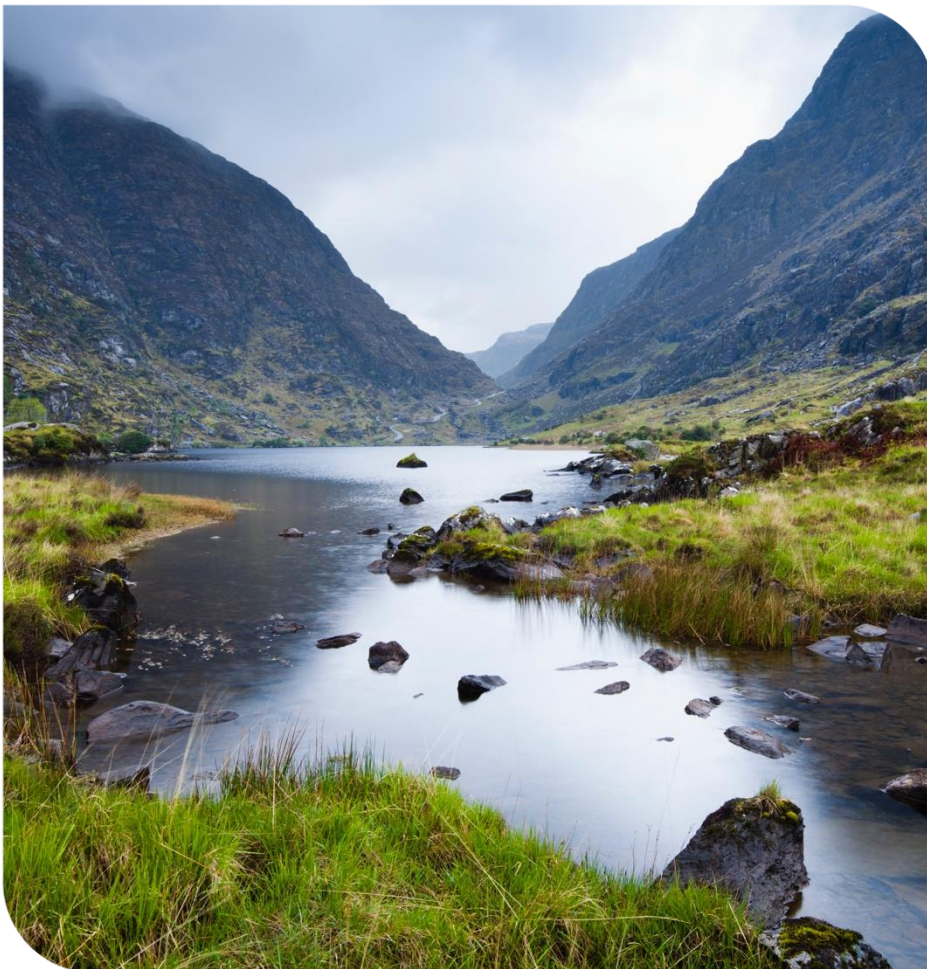

Moville Sewerage Scheme

Frequently Asked Questions



List of Questions

Moville Sewerage Scheme Frequently Asked Questions	
1. Why is this project needed?	1
2. What are the benefits of delivering this project?	1
3. What stage is the project at?	1
4. What is proposed to be constructed as part of this project?	2
5. What will the proposed pumping station and wastewater treatment plant look like? ..	2
6. What is proposed at the River Row Pumping Station?	3
7. What level of treatment will be used?	3
8. How much spare capacity will be available in the Wastewater Treatment Plant?	4
9. Have alternative sites been considered?	4
10. How reliable is a Wastewater Treatment Plant? Can it break down and what would happen if it did?.....	4
11. Will the Wastewater Treatment Plant cause any odours?	5
12. What effect will the discharge have on the shell fish production in Lough Foyle?	5
13. How is the current scheme different to what was proposed before?.....	5
14. Why has Greencastle not been included as part of proposed project?.....	5
15. Why is Irish Water not proposing to discharge treated wastewater into open waters north of Lough Foyle?.....	5
16. How will the proposed project affect the bathing beaches on the shores of Lough Foyle?	6
17. What is the previous planning history of the scheme?.....	6
18. Was An Bord Pleanála's decision appealed?.....	7
19. Did the European Court of Justice rule against the planning permission granted by An Bord Pleanála?	7
20. What is the land acquisition history of the scheme?	7
21. Will Compulsory Purchase Orders be required as part of this project?.....	8
22. Can Irish Water apply for planning permission in Lough Foyle?.....	8
23. Where can I find out more?.....	8

Frequently Asked Questions

1. Why is this project needed?

Untreated wastewater from Moville is being discharged into the Bredagh River and Lough Foyle at five locations, see Figure 1 for an example of one of these locations. Moville is one of the areas the Environmental Protection Agency (EPA) identified as having no wastewater treatment. The Environmental Protection Agency has classified the Bredagh River as being 'Seriously Polluted'.



Figure 1 Current sewage discharge, Moville

The current discharges of untreated wastewater are also polluting Lough Foyle, the beaches and coastline. Figure 2 shows the sewage related litter that can be found in Moville.

The discharge of untreated wastewater threatens water quality, pollutes the environment and detracts from the amenity value of the river and the coastal waters around Moville and environs. A new wastewater treatment plant and collection system is needed to end this practice.



Figure 2 Example of sewage related litter at Moville

The proposed project will end the discharge of untreated wastewater (the equivalent of 2,800 wheelie bins per day)

into Lough Foyle and the Bredagh River.

2. What are the benefits of delivering this project?

The new wastewater treatment plant and associated infrastructure will:

- Stop pollution of the Bredagh River and Lough Foyle;
- Restore water quality and the environmental integrity of the Bredagh River;
- Allow the decommissioning of more than 15 temporary treatment plants in housing developments in Moville by connecting them to the public sewer system;
- Stop ongoing pollution of local beaches;
- Facilitate social and economic development; and
- Ensure compliance with national and EU regulations relating to the treatment and discharge of wastewater.

3. What stage is the project at?

The project is in the planning and design stage. Irish Water is currently undertaking on-the-ground investigations and engaging with landowners and the local community. Once our investigations are complete we expect to submit a planning application to the planning authority for their consideration by the end of 2019.

Detailed design and construction will be completed by 2022, subject to statutory approvals.

4. What is proposed to be constructed as part of this project?

The proposed project will involve the construction of the following:

- New wastewater collection sewers in Moville;
- A new wastewater treatment plant (WWTP) at Carnagarve serving a population equivalent (PE) of 3,500;
- A new pumping station and storm water storage tank at River Row, Moville;
- A new outfall pipe that will safely discharge treated wastewater into Lough Foyle, approximately 200-300m from the shoreline, at a depth of at least 10m at low tide.

Following the construction of the sewers and the outfall pipe all lands and the shore will be reinstated to their current condition.

5. What will the proposed pumping station and wastewater treatment plant look like?

We are still completing detailed design of the scheme. Indicative plans have been prepared for the WWTP and Pump Station, see **Figures 3** and **Figure 4** below:

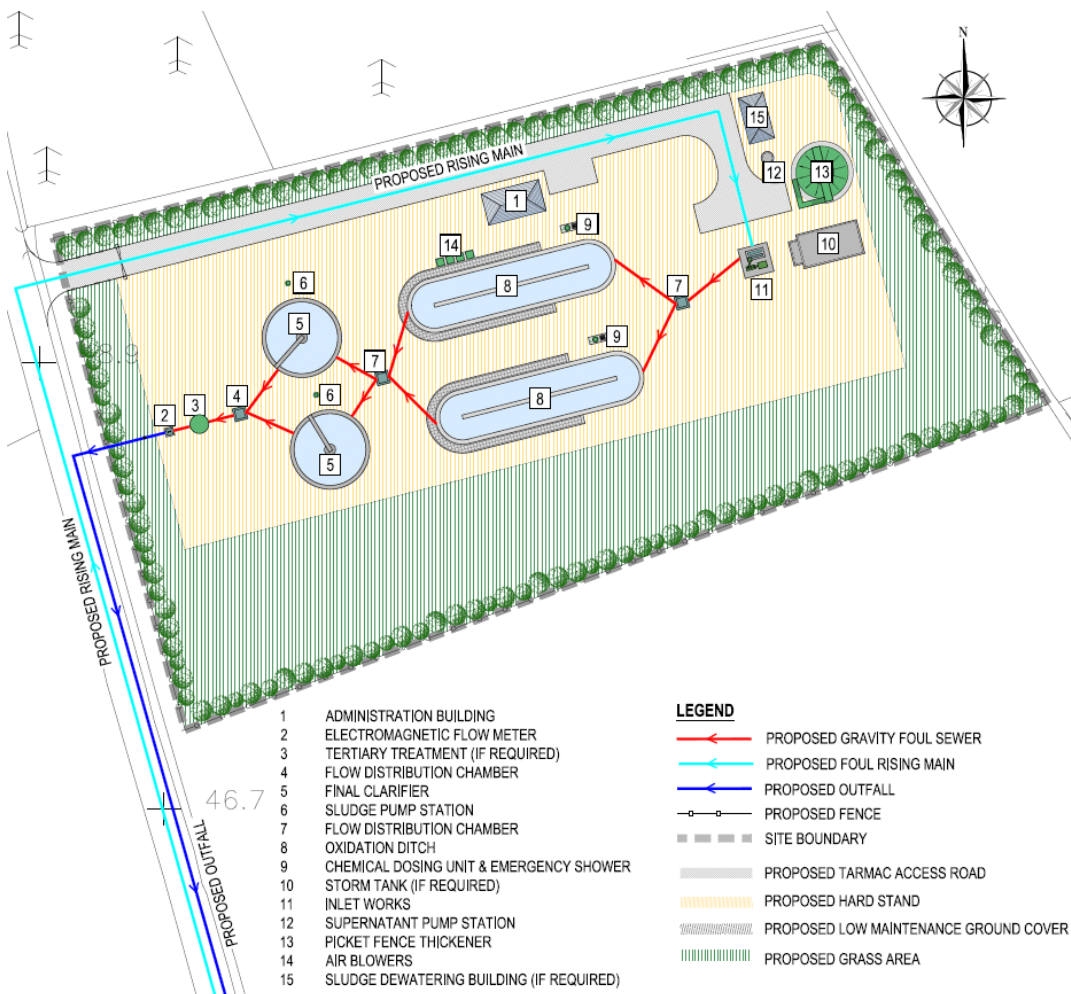

Figure 3: Possible Layouts of WwTP at Carnagarve

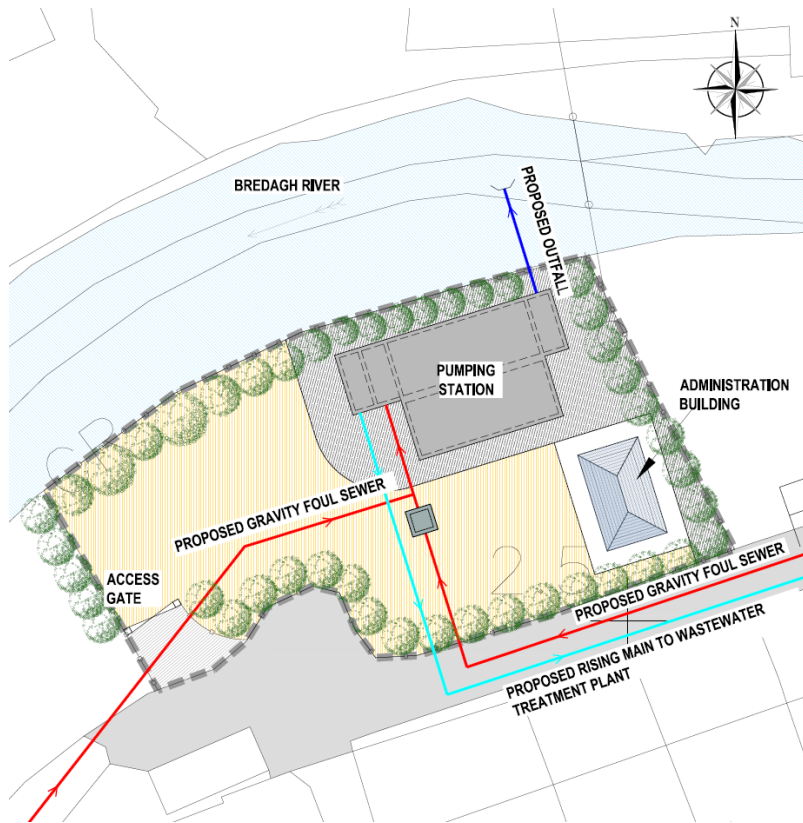

Figure 4: Possible Layout of River Row Pump Station

6. What is proposed at the River Row Pumping Station?

New wastewater collection sewers will collect the wastewater from Merville, and bring it to the new pumping station at River Row, Merville. From here, the wastewater will be pumped via a new sewer to the proposed new Wastewater Treatment Plant in Carnagarve for treatment.

The proposed pumping station will include a storm tank. The storm tank will be sized and designed to cater for extra flows during heavy storms. When storm flows subside, the wastewater in the storm tank will then be pumped to the wastewater treatment plant for treatment.

7. What level of treatment will be used?

This will be confirmed following completion of dispersion modelling within Lough Foyle. A dispersion model is a computer simulation which shows how treated wastewater will be diluted and carried away once it's discharged to the environment.

Irish Water will assess the results of the dispersion modelling exercise and will propose the appropriate treatment level to meet all of the environmental and legislative requirements.

Ultimately, the Environmental Protection Agency will review Irish Water's proposals and will confirm the level of treatment required.

At a minimum the wastewater treatment plant will include:

- a) Preliminary treatment - screening and oil, fat, grease and grit removal;
- b) Secondary treatment - biological treatment and settlement; and,
- c) If required, Tertiary treatment - ultra violet disinfection and/or filtration.

8. How much spare capacity will be available in the Wastewater Treatment Plant?

Irish Water has sized the plant to ensure that there will be enough capacity for at least the next 10 years. The plant will be designed to serve a population equivalent of 3,500, which takes into account the following:

- the number of houses and occupants in Moville, including those currently served by private package wastewater treatment plants;
- the number and load from non-domestic properties connected to the system (e.g. bars, restaurants, hotels, shops, garages, schools, community facilities, etc);
- population growth for the next 10 years, which includes for industrial growth and seasonal fluctuations due to tourism; and
- an additional 10% capacity.

Finally, the site is large enough that should there be further growth in the area the plant can be expanded.

9. Have alternative sites been considered?

Alternative wastewater treatment plant sites were considered as part of the planning and compulsory purchase order applications made by Donegal County Council (DCC) to An Bord Pleanála in 2011. An Bord Pleanála confirmed the compulsory purchase order for the site, which is still valid.

10. How reliable is a Wastewater Treatment Plant? Can it break down and what would happen if it did?

We design, build and maintain all of our wastewater treatment plants to be reliable by:

- a) Using robust and proven mechanical and electrical equipment;
- b) Providing standby equipment with automatic changeover for critical elements of the process i.e. if a pump fails a standby pump will automatically be brought into operation;
- c) Using a standby power generator during times of ESB network failure;
- d) Providing 24 hour a day monitoring using a supervisory, control and data acquisition system together with emergency notifications to plant caretakers;
- e) Proactive plant maintenance in accordance with equipment manufactures servicing schedules; and,
- f) Using appropriately trained plant operators for daily plant inspections, sampling, testing, and equipment calibration.

In the event of a plant failure, flows from the River Row Pumping station will be stopped and inflows will be managed using the storm water storage tanks at the River Row site. This means that the proposed treatment plant will not discharge untreated effluent into Lough Foyle.

11. Will the Wastewater Treatment Plant cause any odours?

Irish Water will provide sealed tanks and odour scrubbing equipment on the parts of the treatment process that generate significant odours. This will ensure that our staff do not have to work in a malodorous environment and that no odour nuisance is created locally.

It is expected that the Planning Authority will include strict odour standards in any grant of planning permission which Irish Water will be legally obliged to adhere to.

Irish Water will also comply with national legislation on odour (and noise) mitigation i.e. compliance with 'Statutory Instrument No. 787/2005 - European Communities (Waste Water Treatment) (Prevention of Odours and Noise) Regulations 2005'.

12. What effect will the discharge have on the shell fish production in Lough Foyle?

The proposed scheme will significantly improve water quality in Lough Foyle, by removing a significant source of pollution. The proposed project should therefore have an overall positive impact on the quality of shell fish in Lough Foyle.

13. How is the current scheme different to what was proposed before?

The current project will serve a Population Equivalent (PE) of 3,500 in order to serve Moville. The previous scheme included for an 8,800 PE treatment plant to serve both Moville and Greencastle.

Irish Water proposes to locate the storm water tank at the River Row Pumping Station as opposed to locating it at the wastewater treatment plant. This means that there will be no storm water discharges from the proposed wastewater treatment plant in Carnagarve.

14. Why has Greencastle not been included as part of proposed project?

Irish Water is obliged to prioritise communities which are included on the Environmental Protection Agency's (EPA) list of untreated agglomerations (urban area serviced by a sewer system). Moville is one of these communities as it is discharging untreated wastewater into the Bredagh River and Lough Foyle. Moville is urgent need of a wastewater treatment plant.

Irish Water owns and is responsible for some of the wastewater assets in Greencastle, which are authorised by the Environmental Protection Agency. At present there is no requirement to upgrade these assets.

15. Why is Irish Water not proposing to discharge treated wastewater into open waters north of Lough Foyle?

A discharge point north of Lough Foyle would result in a significantly longer piped network that would increase both the both the capital, operational costs and the carbon footprint of the project.

During the compulsory purchase process in 2011 An Bord Pleanála determined that there is a community need for a wastewater treatment plant and that:

- The Carnagarve site is suitable to meet the community need;
- The development is compatible with proper planning and sustainable development of the area; and
- Alternative sites were considered.

An Bord Pleanála, and Irish Water, are satisfied that alternatives were considered and that the Carnagarve site is the most suitable site to treat and discharge wastewater.

16. How will the proposed project affect the bathing beaches on the shores of Lough Foyle?

The discharge of raw untreated wastewater directly into the Bredagh River and Lough Foyle is currently having a negative impact on the water quality and on the local beaches. Treating and safely discharging treated wastewater will significantly improve the current situation and will protect the bathing areas.

The purpose of this project is to stop raw effluent from entering Lough Foyle by treating the influent to a high standard. Raw effluent will not have any impact on beaches once the project is delivered. The project will protect local beaches and Lough Foyle.

The scheme will result in a significant environmental improvement with improved water quality in the Bredagh River, Lough Foyle and at local beaches.

The proposed project will be assessed by the Planning Authority and the Environmental Protection Agency to ensure that the environmental objectives will be consistently met.

17. What is the previous planning history of the scheme?

Donegal County Council developed plans to build an 8,800PE wastewater treatment plant with an outfall into Lough Foyle at Carnagave. In August 2008, the Council applied to An Bord Pleanála (ABP) for permission to construct the scheme. An oral hearing was convened by ABP which allowed interested parties to raise objection and concerns. Following consideration of the Council's application and submissions made to the process ABP granted permission for the scheme on 12th August 2011.

An Bord Pleanála decision included the following:

“... having considered the reports of the Inspector who conducted the oral hearing, including the assessment of the environmental impacts of the scheme, it is considered that, subject to compliance with the conditions set out below, including the omission of the proposed sewers and pumping station at Glenburnie, the proposed development would:

- *represent an acceptable approach to resolving the serious on-going polluting discharges to Lough Foyle and*
- *be acceptable in terms of traffic safety and convenience of road users.*

In the context of the above the Board therefore considered that the proposed development would not result in significant adverse effects on the environment in respect of:

- *the amenities of the area or of property in the vicinity of the treatment plant or pumping stations,*
- *the water quality, ecology, aquaculture or recreational amenities of Lough Foyle,*
- *the ecology of any designated ecological sites forming part of the Natura 2000 network,*
- *the cultural heritage of the area or*
- *the character of the landscape or the visual amenities of the area.*

The proposed development would, therefore, be in accordance with the proper planning and sustainable development of the area.”

18. Was An Bord Pleanála’s decision appealed?

A judicial review of this decision was taken to the High Court by a member of the public. Judgement was delivered on 26 August 2013. The Court rejected all of the complaints made. The Court upheld An Bord Pleanála’s decision, stating that the evidence “overwhelmingly demonstrates that the sooner this project commences the better. It is a great pity it has been delayed so long”.

In conclusion, the Court observed that:

- (a) “twenty times the effluent flows into the Lough from the Northern Ireland side than from the Ireland side”;
- (b) the “purpose of the project...is the improvement of the water quality in Lough Foyle”;
- (c) the “overall impact of the scheme on water quality would be positive”;
- (d) the then “present situation is untenable”;
- (e) the project would “greatly enhance the water of this beautiful Lough to the great benefit of all”; and,
- (f) the evidence “overwhelmingly demonstrates that the sooner this project commences, the better. It is a great pity it has been delayed so long”.

No attempt was made to appeal this High Court decision.

19. Did the European Court of Justice rule against the planning permission granted by An Bord Pleanála?

No, a case regarding the planning decision or any aspect of the scheme was not submitted to or heard by the European Court of Justice.

20. What is the land acquisition history of the scheme?

In October 2009, prior to the establishment of Irish Water, Donegal County Council applied to An Bord Pleanála for a Compulsory Purchase Order for lands associated with the proposed site. This was approved by An Bord Pleanála, and their determination on the site is still valid and in place.

Irish Water took over the interest in this land from Donegal County Council along with other water services assets in 2015.

21. Will Compulsory Purchase Orders be required as part of this project?

Some of the sites which are planned for the scheme were obtained through compulsory purchase orders in 2011, which have been approved by An Bord Pleanála and are still valid.

Irish Water will require wayleaves to construct sewers on private lands in Moville. Irish Water is currently engaging with landowners to acquire the necessary wayleaves. Consent through negotiation is Irish Water's preferred approach to advancing agreements with landowners. Compulsory Purchase is used in some instances where land title is unclear, where land is subject to probate, or where agreements cannot be reached.

22. Can Irish Water apply for planning permission in Lough Foyle?

Irish Water will engage with all of the necessary statutory authorities to ensure that all of necessary consents are obtained.

23. Where can I find out more?

To find out more about the proposed scheme please see our website: <https://www.water.ie/projects-plans/our-projects/moville-sewerage-scheme>

This is updated on a regular basis. If you require further information, you can contact the Project Team on movilleww@water.ie

For more general information on Irish Water and the work we are doing:

Visit: www.water.ie

Telephone: 1890 278 278

Minicom: 1890 378 378 (for hearing impaired customers with their own minicom equipment)

Twitter: @irishwater

www.facebook.com/IrishWater

ervia



Gas
Networks
Ireland

