

Sectional Elevation Looking North - Elevation 3
Scale 1:200

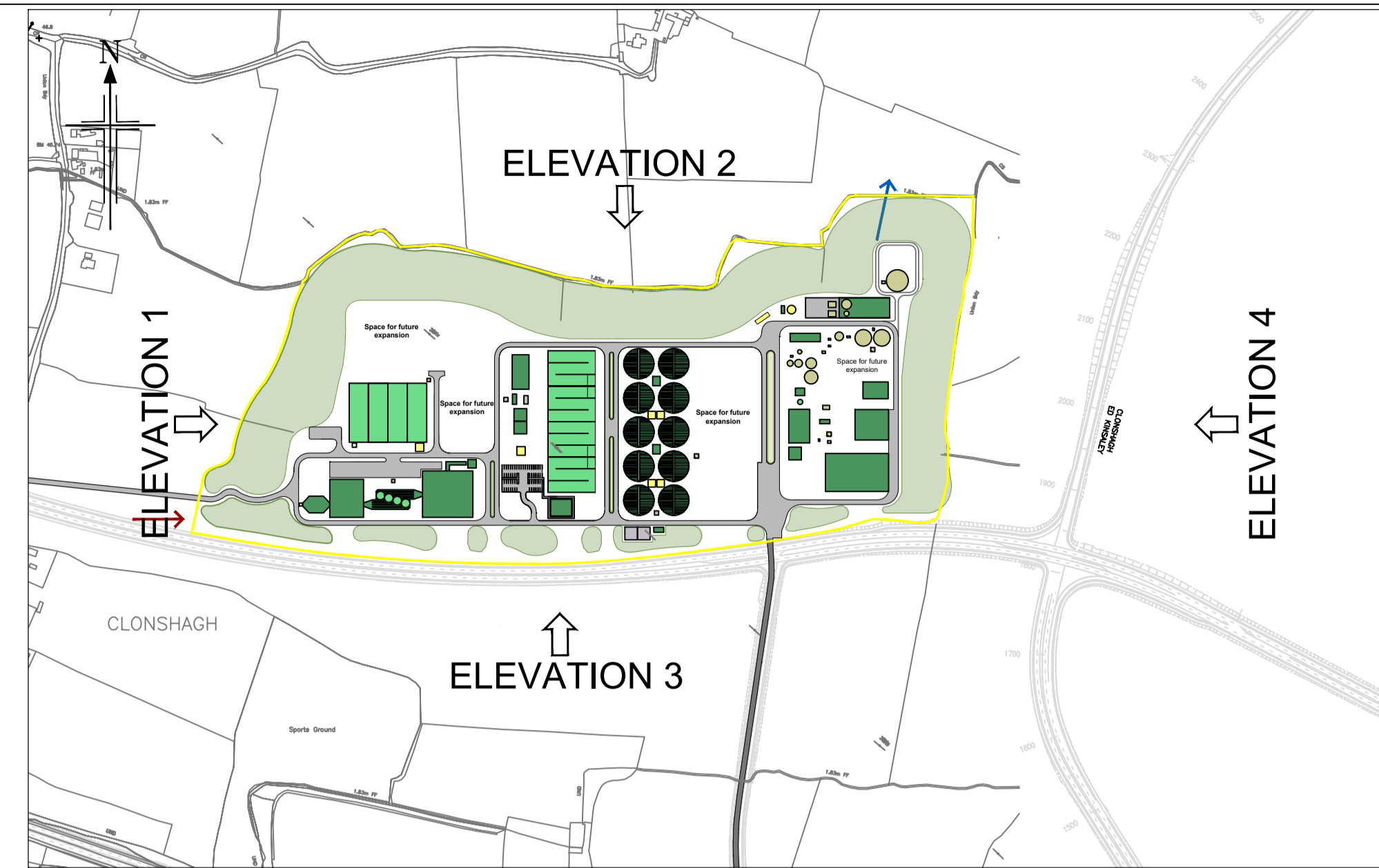

Site Plan
Scale 1:7500

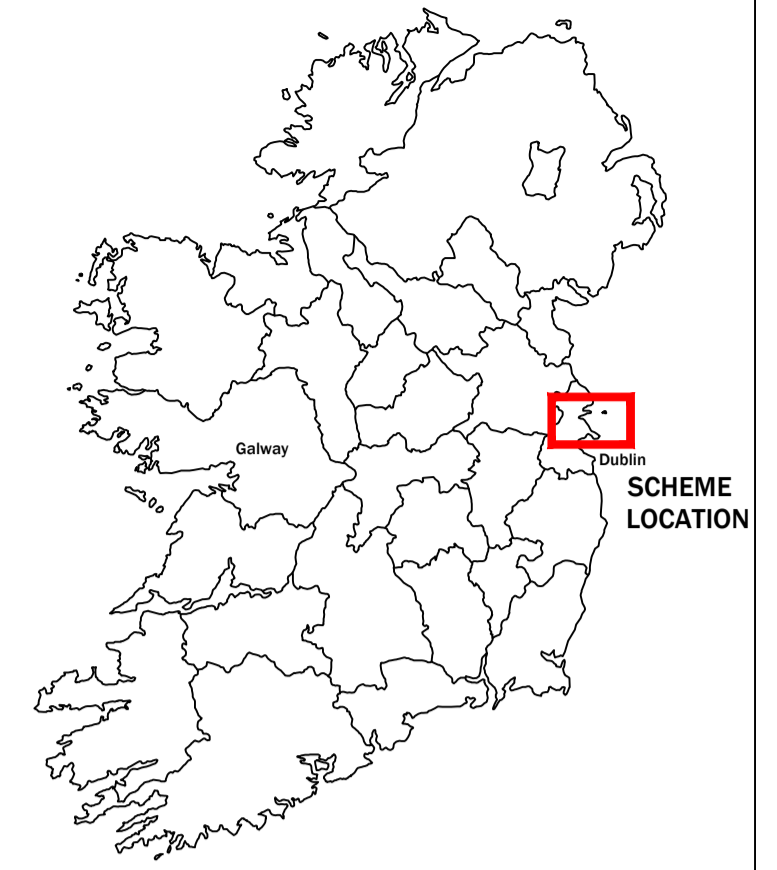

- Notes:
1. This drawing is not to be scaled. Figured dimensions only to be taken.
 2. The Process type and arrangement shown requires confirmation by outline design.
 3. 38kV Power line passes through the proposed land boundary. It is assumed that the power line to be re-routed around site boundary.
 4. All earthworks shall be at a maximum slope of 1V : 2H.
 5. All tanks shall be covered with GRP clam shell covers.
 6. All drawings to be checked by the Contractor on Site.
 7. Engineer to be informed by the Contractor of any discrepancies before any work commences.
 8. All levels shown relate to Ordnance Survey datum at Malin Head, the geographic coordinate system is to Irish Transverse Mercator (ITM).
 9. UV building's dimensions and the dimension is taken from a cut through the building based on its orientation.

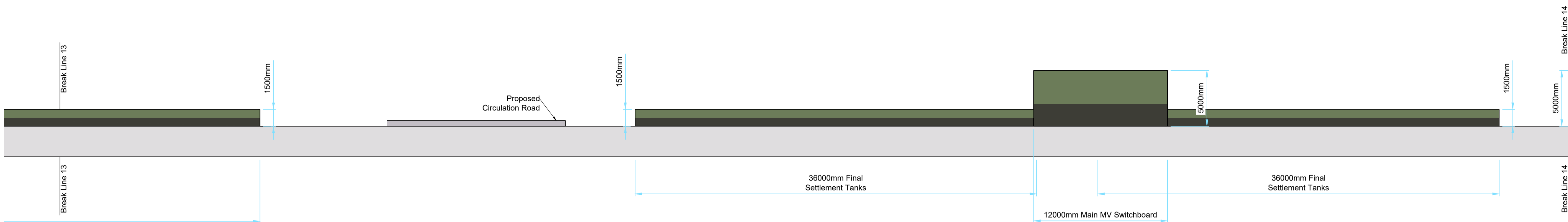

Sectional Elevation Looking North - Elevation 3
Scale 1:200

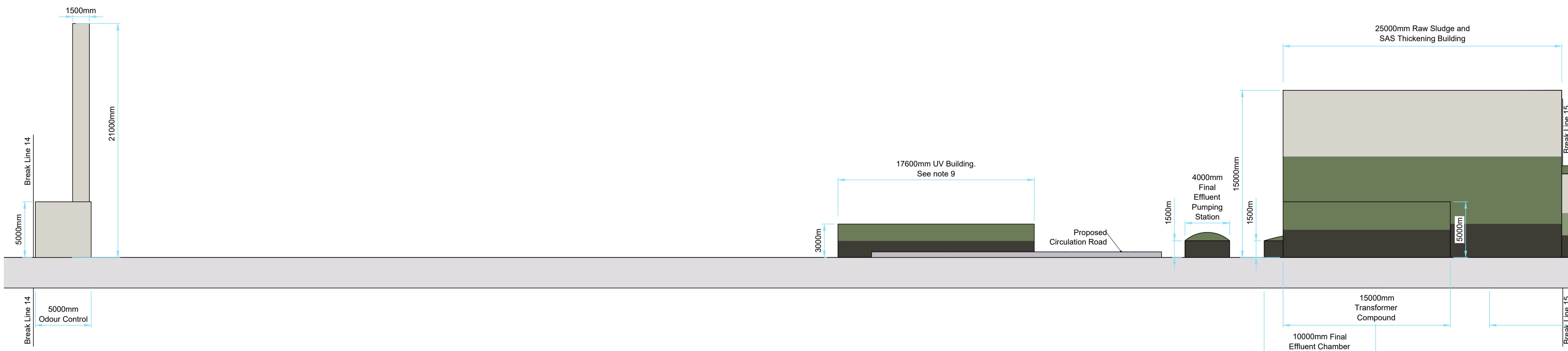

Sectional Elevation Looking North - Elevation 3
Scale 1:200

P02	09.10.23	Issued for Planning Remittal	MP	OA
P01	June 2016	Issued for Planning	SM	COK
Rev	Date	Description	By	Chkd.



Client:
Uisce Éireann
Irish Water

Project:
GREATER DUBLIN DRAINAGE PROJECT

Drawing Title:
REGIONAL WwTP ELEVATIONS
ASP OPTION - ELEVATION (SHEET 6 OF 8)

Scale @ A1 (DO NOT SCALE): AS SHOWN @ A1
Prepared by: S.Murphy
Checked: C.O'Keefe
Date: 21-12-17

Project Manager: Jillian Bolton
Jacobs Number: 32102902
Drawing Status: Issued for Planning Remittal

Jacobs
This drawing is not to be used in whole or part other than for the intended purpose & project as defined on this drawing. Refer to the contract for full terms and conditions.

Drawing No.: 32102902-2132
Revision: P02