

DISTANCE

for Causeway Geotech

Plate: 10a

AGL15015

by: Strata Geophysical, Inc.
 Data Sets: 1 Date: Feb 2015
 Equipment: Spread: S1

Dublin
 Dublin
 Azimuth:

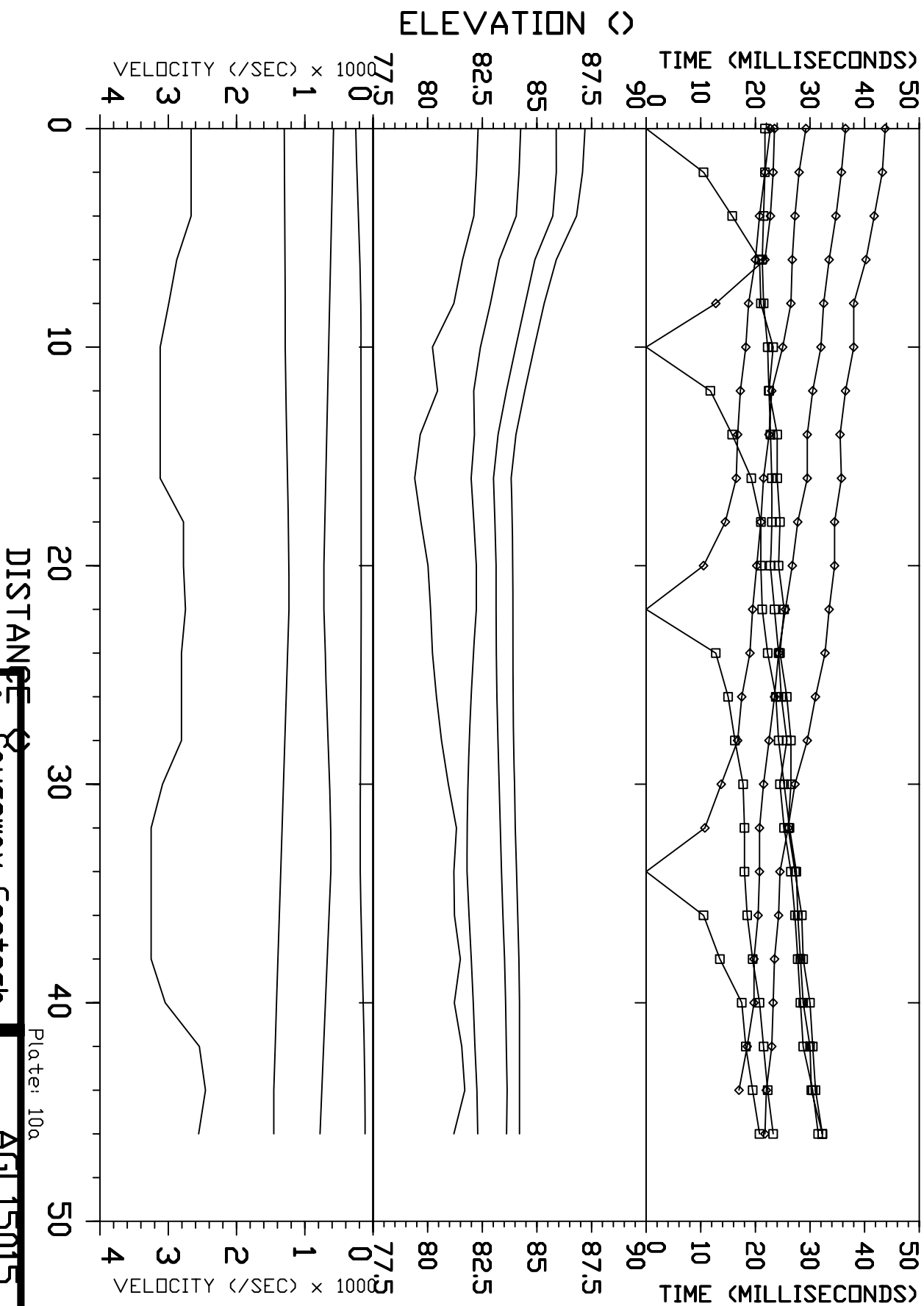

For: Causeway Geotech

AGL15015

by: Strata Geophysical, Inc.

Data SetS2 Date: Feb 2015

Equipment: Spread S2

Plate: 10a

Dublin
Dublin

Azimuth:

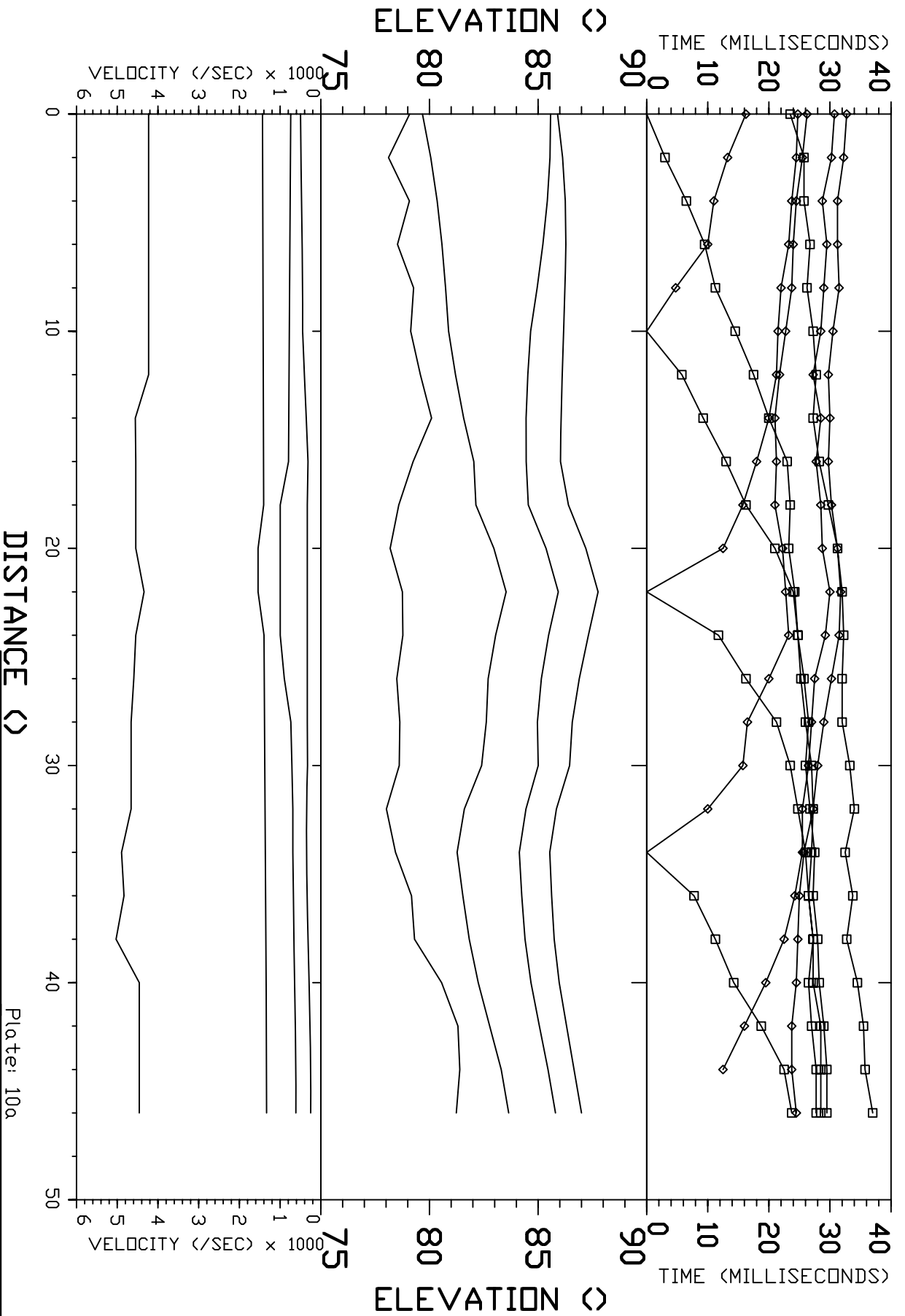

For: Causeway Geotech

by: Strata Geophysical, Inc.

Data Sets: S3 Date: Feb 2015

Equipment: Spread: S3

AGL15015

Dublin
Dublin

Azimuth:

Plate: 10a

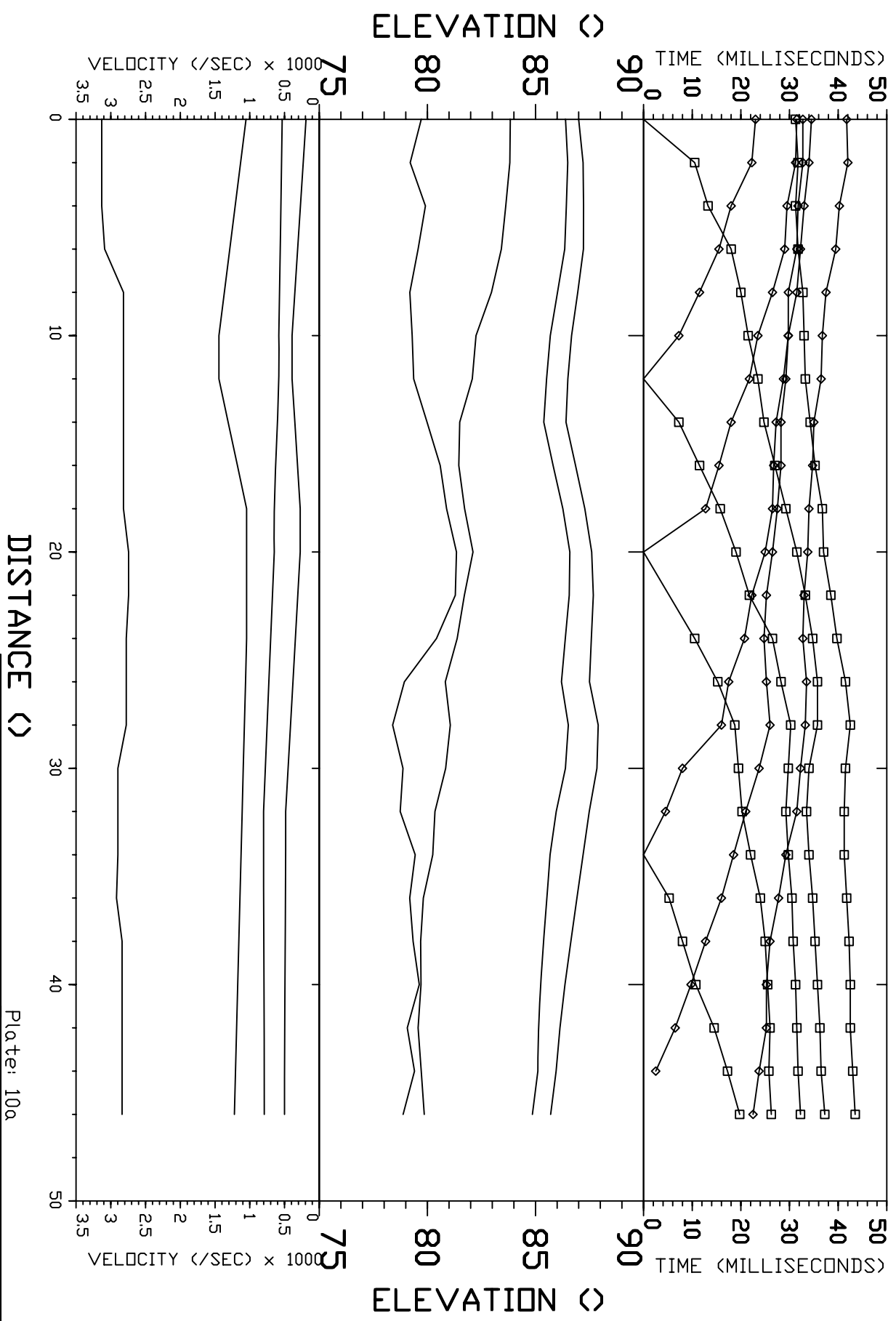

DISTANCE ()

Plate: 10a

for: Causeway Geotech		AGL15015	
by: Strata Geophysical, Inc.		Dublin	
Data Sets4	Date: Feb 2015	Dublin	
Equipment: Spread S4		Azimuth:	

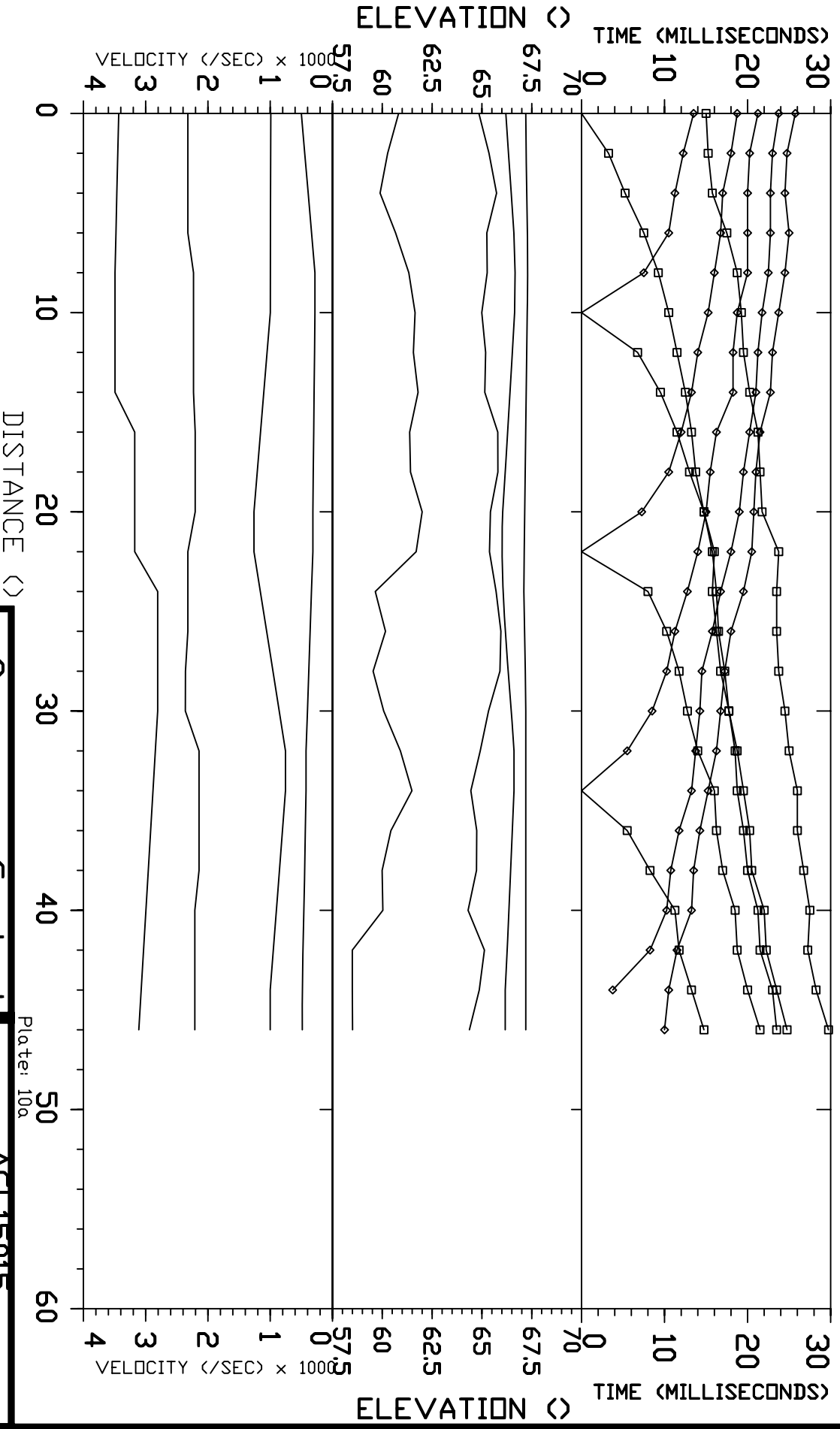

Plate: 10a

fofCauseway Geotech

by: Strata Geophysical, Inc.

Data SetSS Date: Feb 2015

Equipment: Spread S5

AGL15015

Dublin
Dublin

Azimuth:

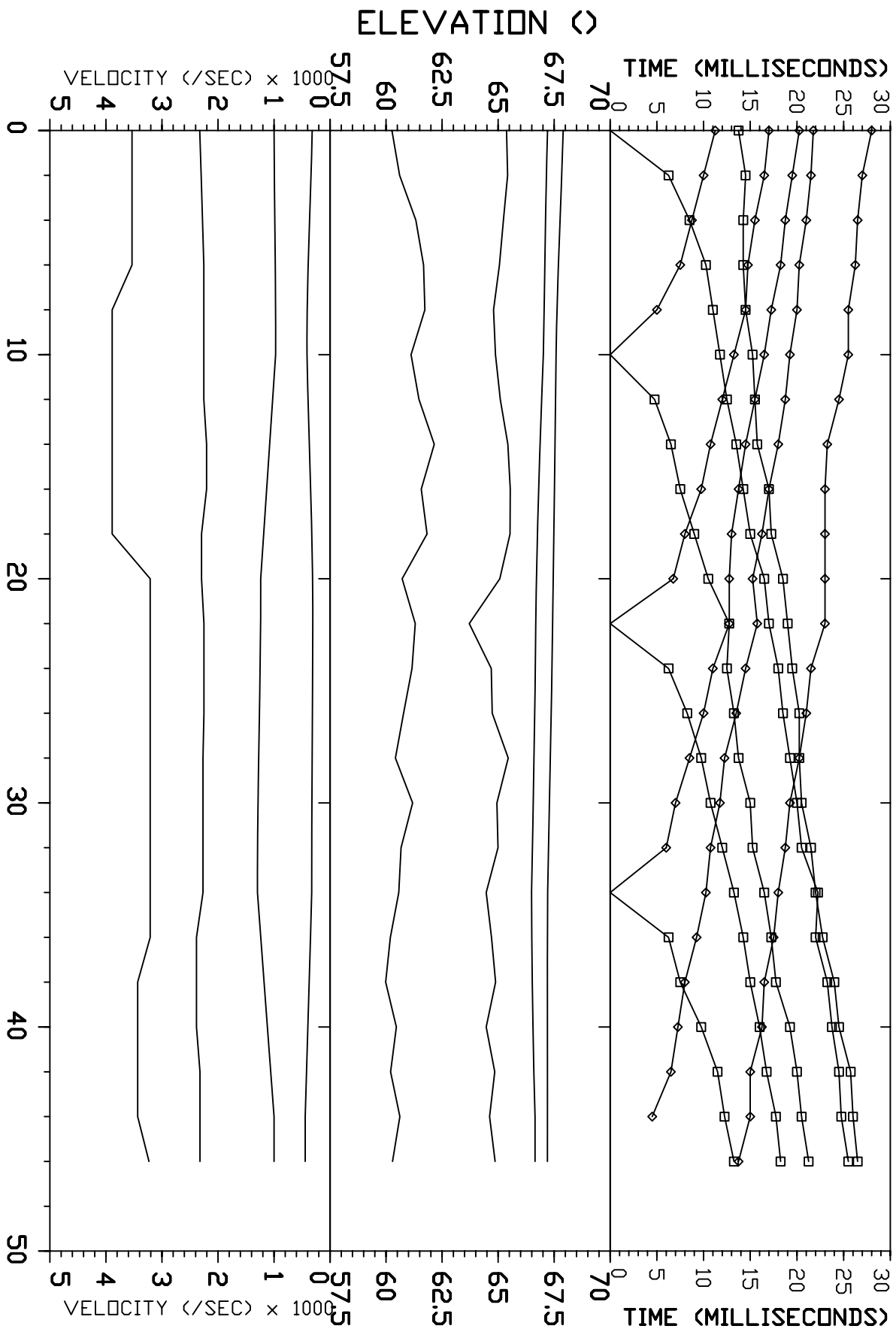

DISTANCE (m)

Plate: 10a

for: Causeway Geotech		AGL15015	
by: Strata Geophysical, Inc.		Dublin Dublin	
Data Sets: S6	Date: Feb 2015	Azimuth:	
Equipment: Spread: S6			

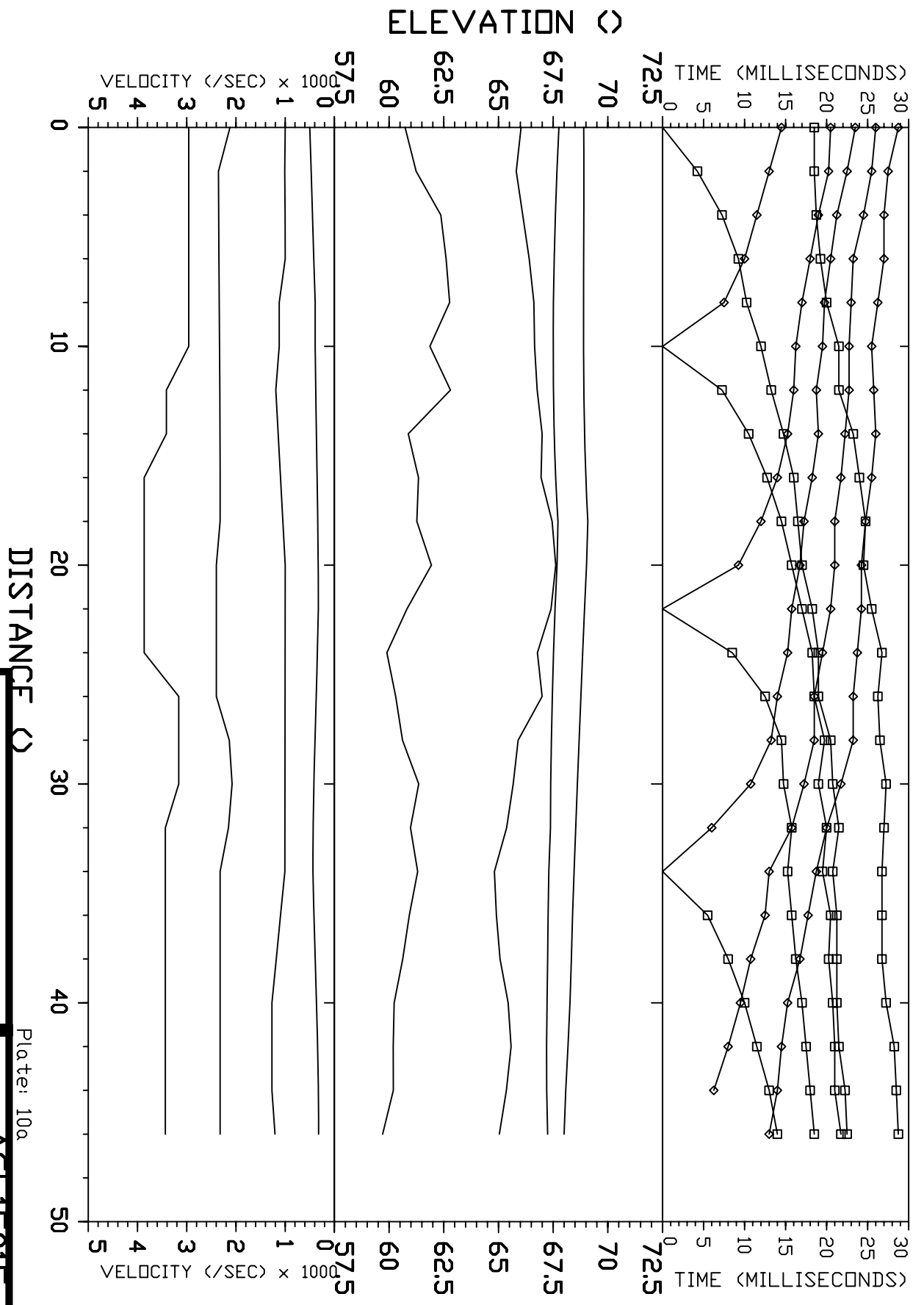

For: Causeway Geotech

by: Strata Geophysical, Inc.

Data Set: S7 Date: Feb 2015

Equipment: Spreadi: S7

AGL15015

Dublin
Dublin

Azimuth:

Plate: 10a

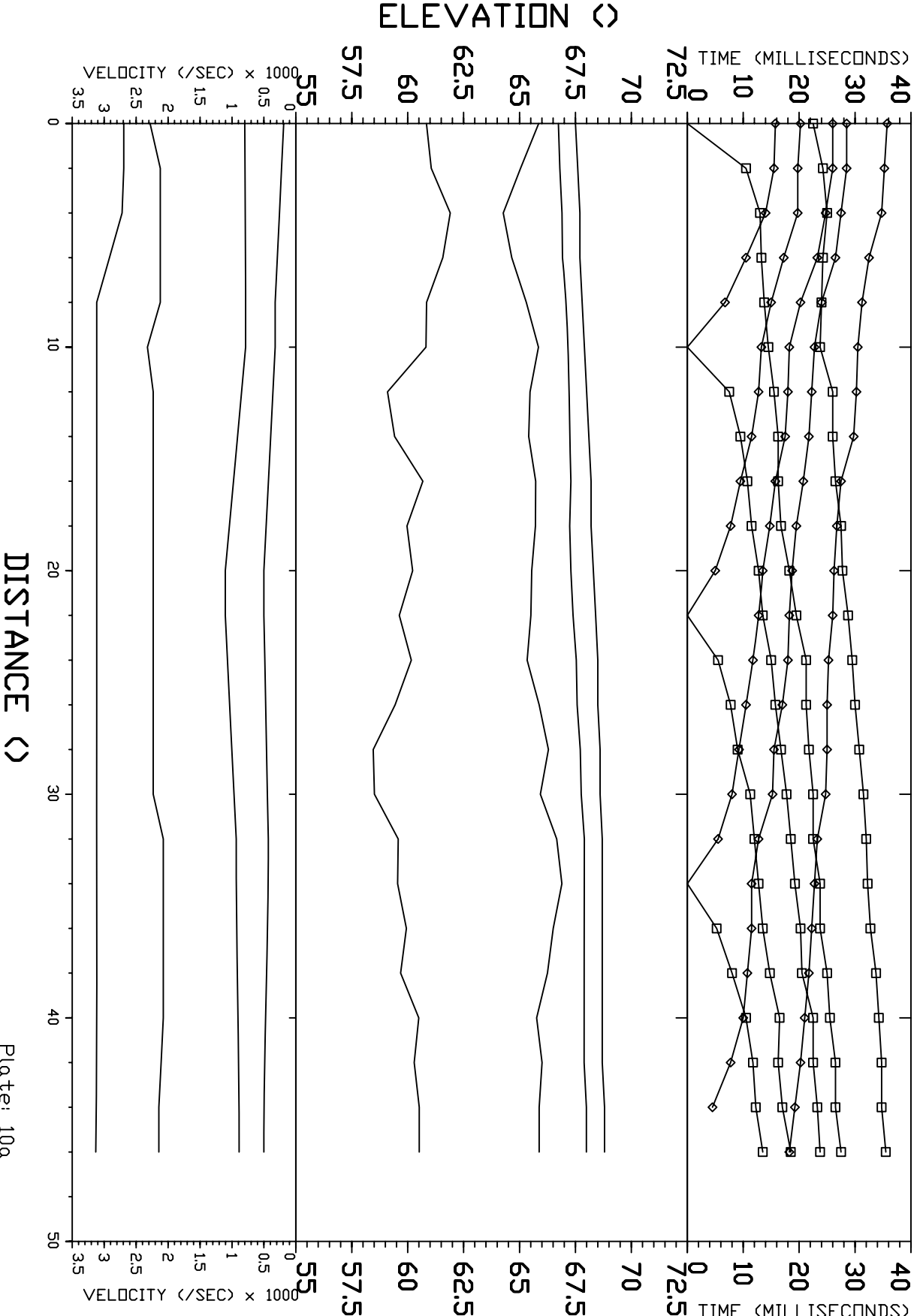

DISTANCE (m)

Plate: 10a

for: Causeway Geotech		AGL15015	
by: Strata Geophysical, Inc.		Dublin Dublin	
Data Sets: S8	Date: Feb 2015	Azimuth:	
Equipment: Spreadi S8			

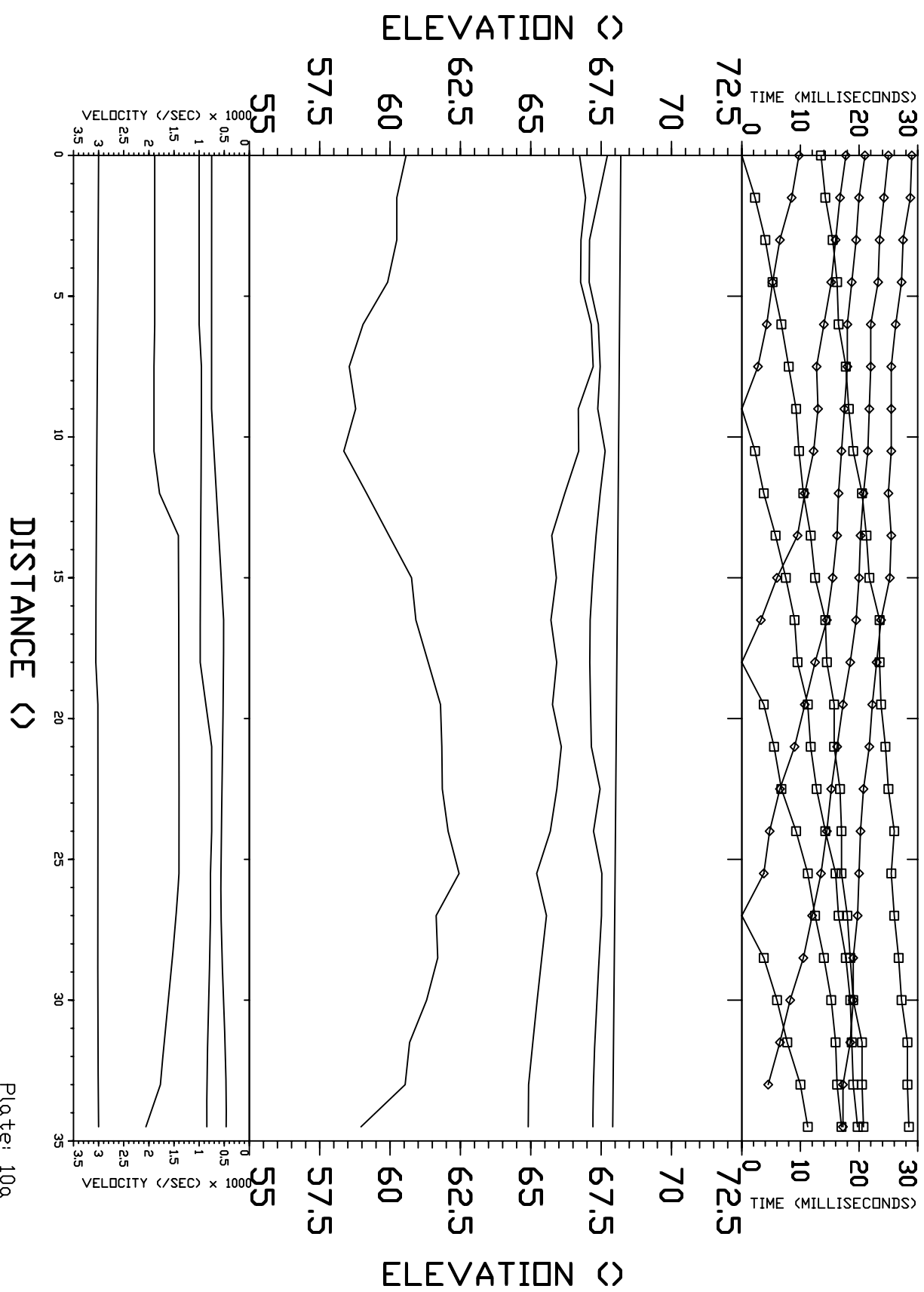
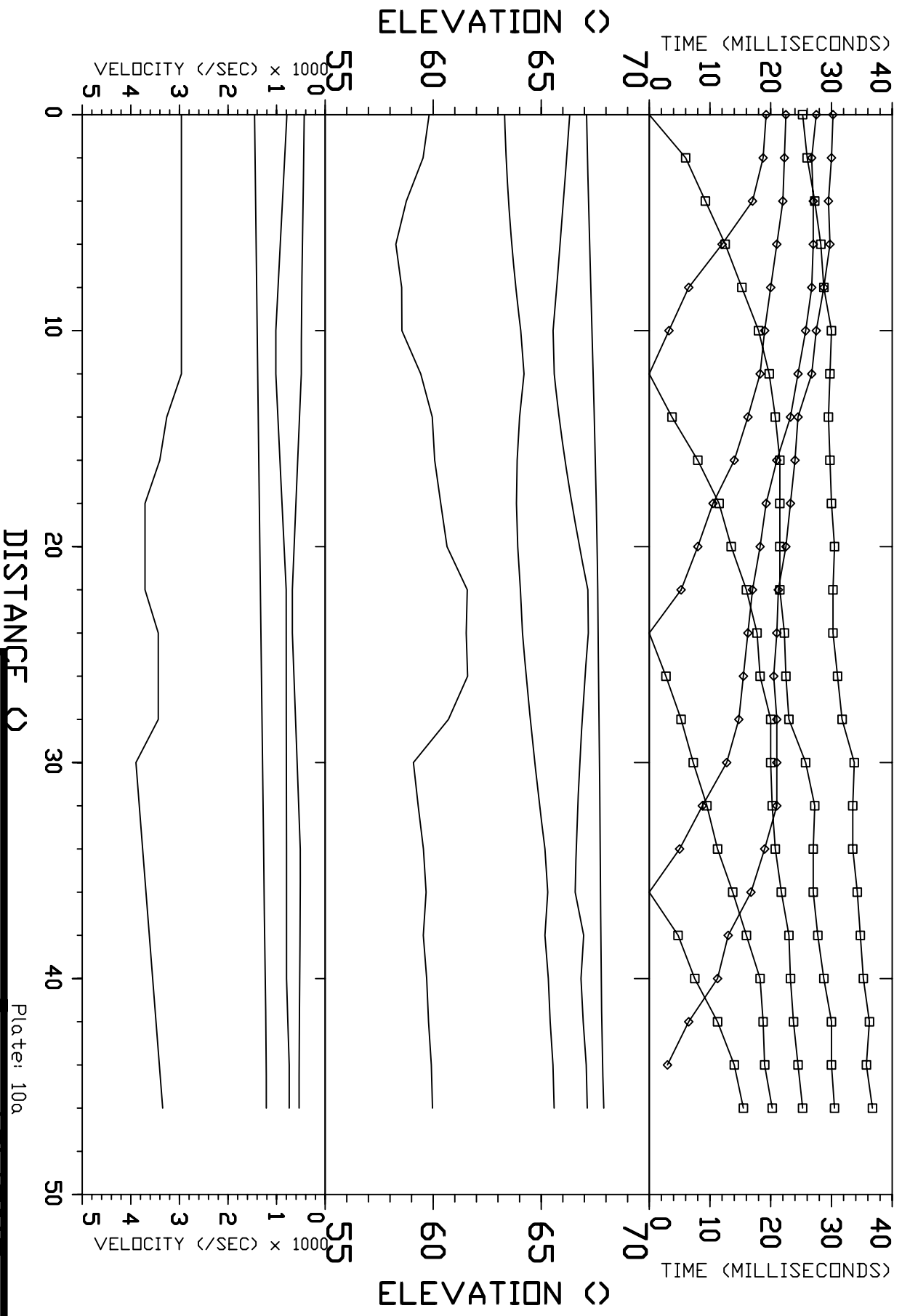

Plate: 10a

for: Causeway Geotech		AGL15015	
by: Strata Geophysical, Inc.		Dublin Dublin	
Data Sets: S9	Date: Feb 2015	Azimuth:	
Equipment: Spread: S9			



For: Causeway Geotech

by: Strata Geophysical, Inc.

Data Sets: S10

Date: Feb 2015

Equipment: Spread: S10

Spread: S10

AGL15015

Dublin
Dublin

Azimuth:

Plate: 10a

8. APPENDIX C: DRAWINGS

The information derived from the geophysical investigation is presented in the following drawings:

AGL15015_01	Geophysical Location	1:4000 @ A3
AGL15015_02	GEO-1 Results	1:750 @ A3
AGL15015_03	GEO-2 Results	1:750 @ A3
AGL15015_04	GEO-3 Results	1:750 @ A3

FIGURE 1: GEO-1 LOCATION

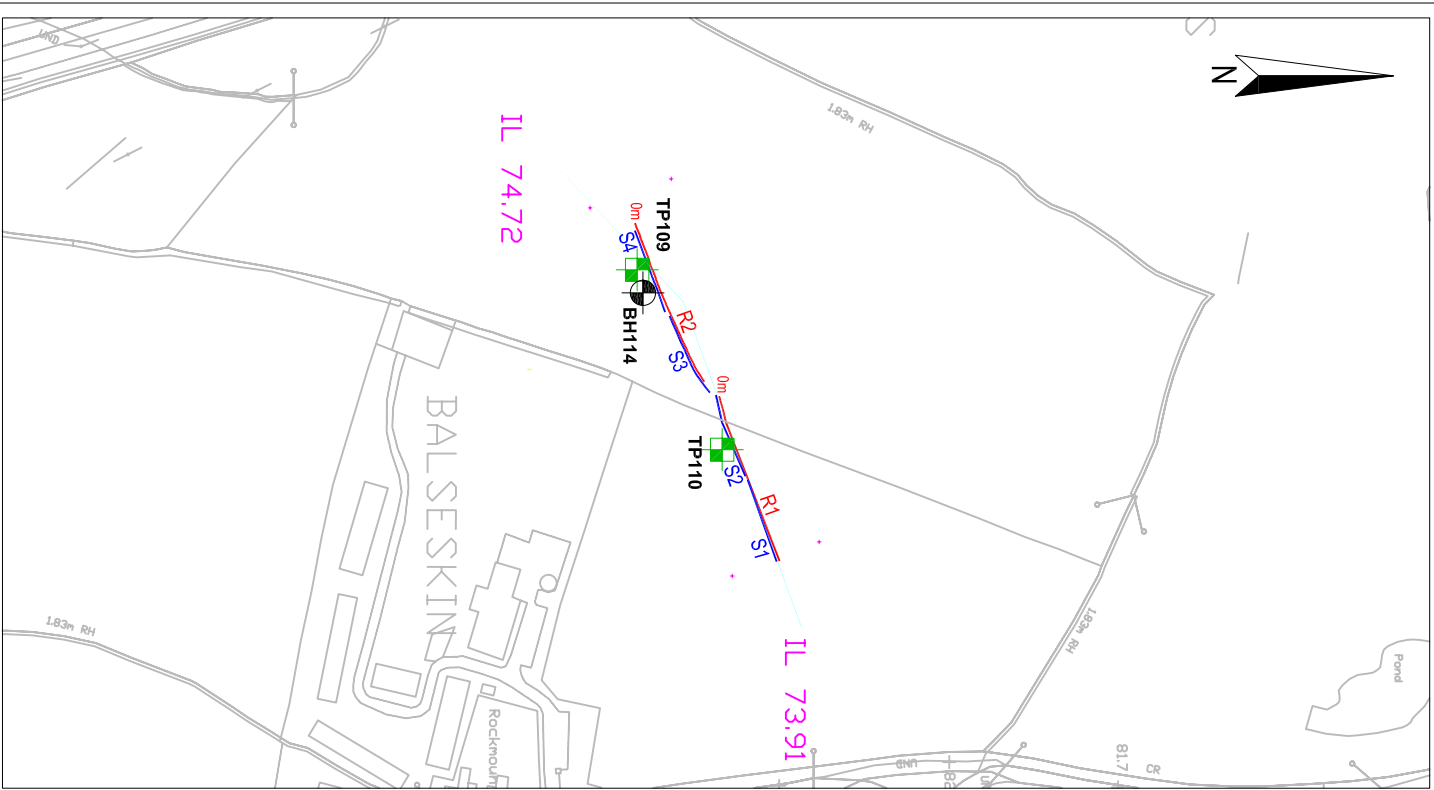
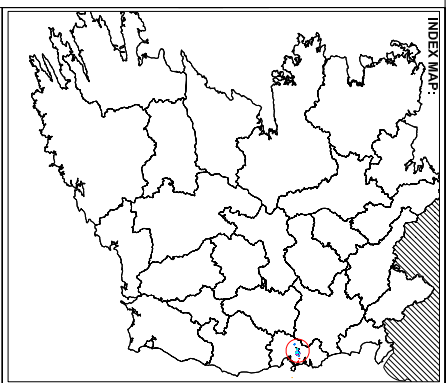
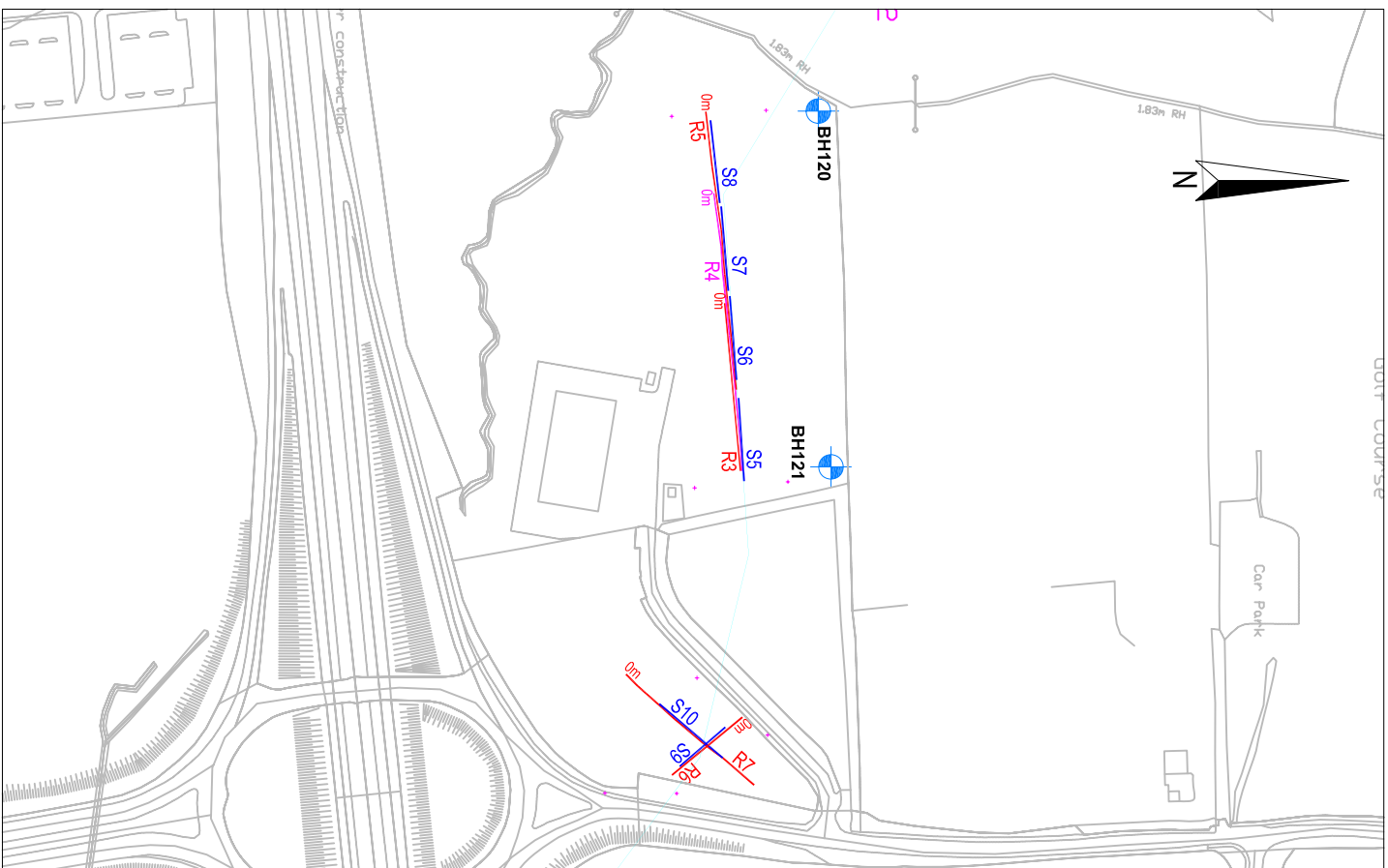

FIGURE 2: GEO-2 & GEO-3 LOCATION



LEGEND:

- ERT Profile
- Seismic Refraction Profile
- Proposed Pipeline



6 Knockmullen Business Park, Regus House, Herald Way
 Gorey, Co. Wexford
 Castle Donington, Derby, DE74 2TZ, UK
 T +353 (0)402-21942 T +44 (0)844 8700 692
 F +353 (0)402-21843 E info@apexgeoservices.co.uk
 www.apexgeoservices.ie www.apexgeoservices.co.uk

PROJECT: GREATER DUBLIN REGIONAL DRAINAGE
 GEOPHYSICAL SURVEY
 CLIENT: CAUSEWAY GEOTECH LTD.

DRAWING NO: AGL15015_01 GEOPHYSICAL LOCATION
 SCALE: 1:4000 @ A3

DATE:	13.02.15
Version:	1
Date:	13.02.15
Drawn By:	SOR
Checked:	TL

FIGURE 1: GEO-1 LOCATION

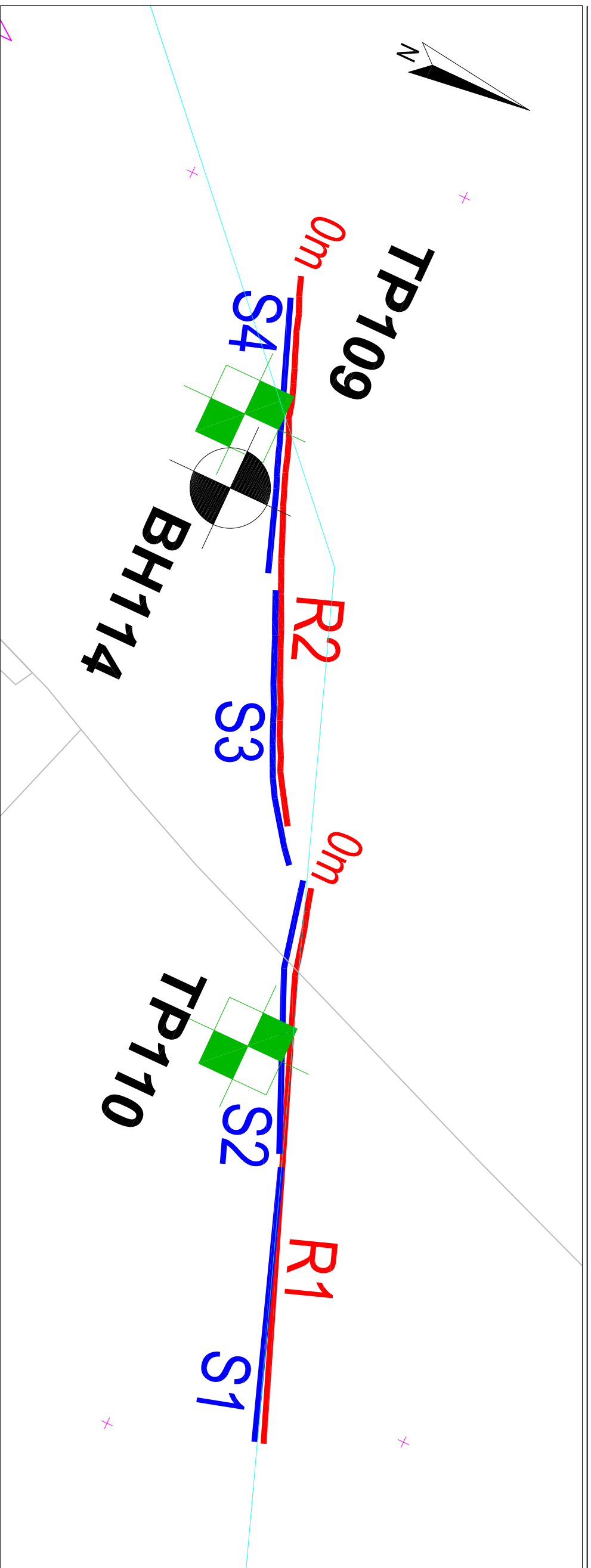
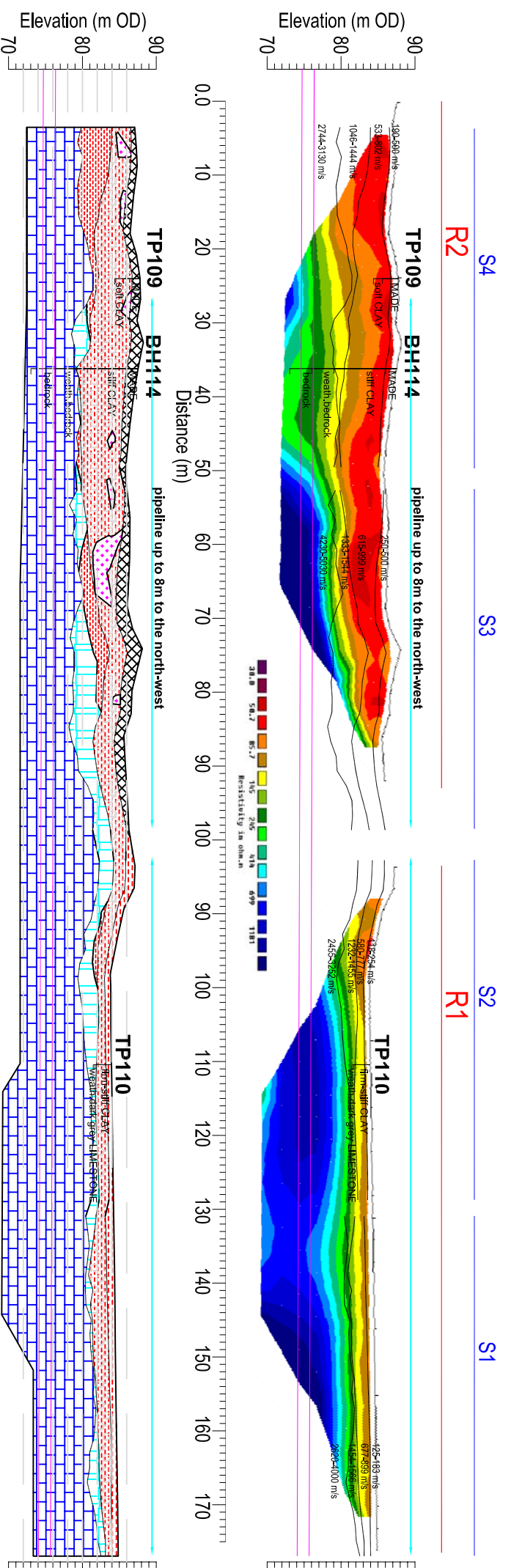

FIGURE 2: GEO-1 INTERPRETED SECTION



Note that the elevations for this section need to be checked against the project datum

apex geoservices

6 Knocknollen Business Park, Regus House, Herald Way
 Gory, Co. Wexford
 Regus Business Park
 Castle Donington
 Derby DE74 2TZ
 Ireland
 T +353 (0)40221842
 F +353 (0)40221843
 E info@apexgeoservices.ie
 www.apexgeoservices.co.uk

PROJECT: GREATER DUBLIN REGIONAL DRAINAGE
 GEOPHYSICAL SURVEY
 CAUSEWAY GEOTECH LTD.

DRAWING NO: AGL15015_02 GEO-1 RESULTS

SCALE: 1:750 @ A3

DATE: 13.02.15

Variant	Date:	Drawn By:	Checked:
1	13.02.15	SOR	TL

INDEX MAP-scale 1:10000@A3

LEGEND:

- Made Ground
- Firm-Stiff SILT/CLAY
- Stiff-very Stiff SILT/CLAY
- Soft-Firm Sandy Gravelly CLAY
- Firm-Stiff Sandy Gravelly CLAY
- Stiff-very Stiff Sandy Gravelly CLAY
- Highly-Moderately Weathered Muddy LIMESTONE & SHALE
- Slightly Weathered-Fresh Muddy LIMESTONE & SHALE

FIGURE 1: GEO-2 LOCATION

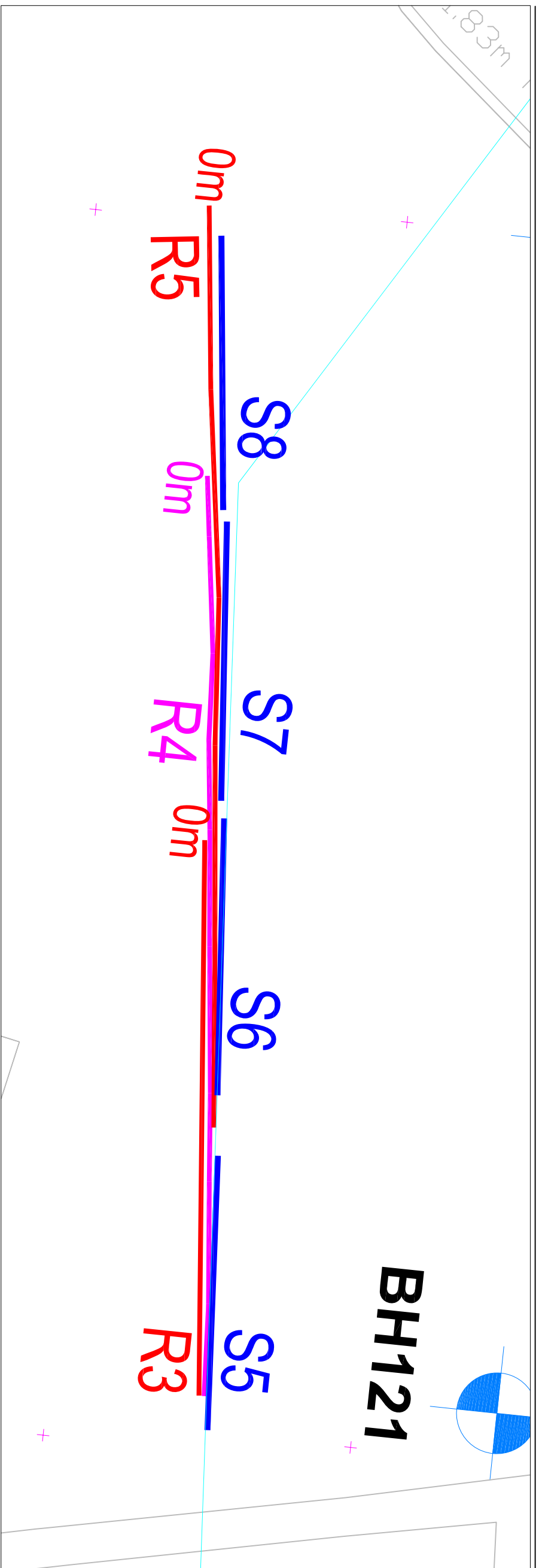
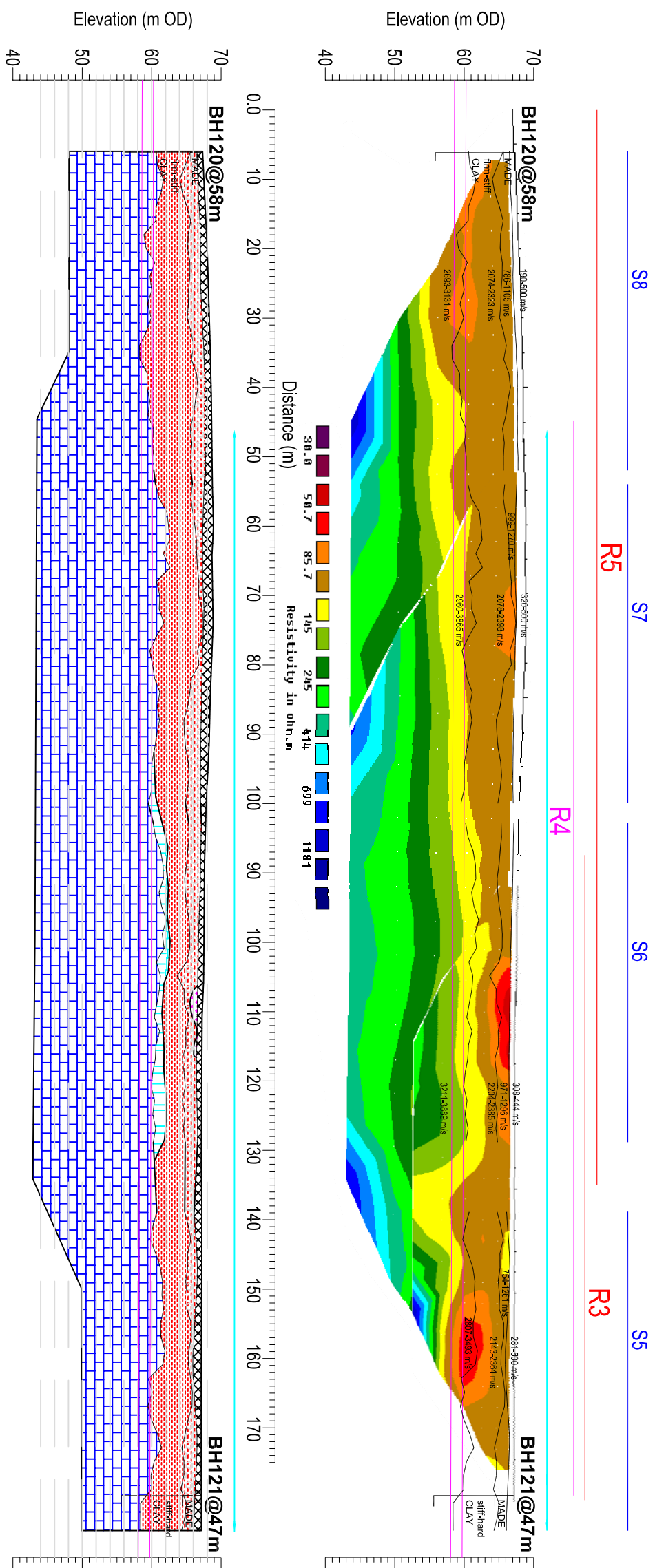
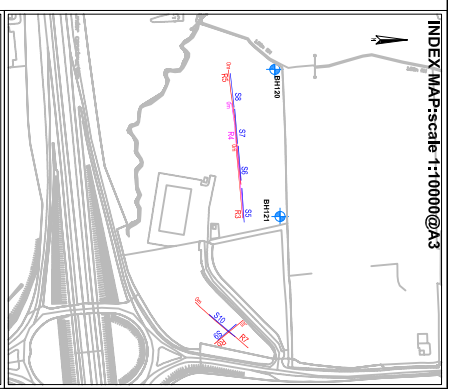

FIGURE 2: GEO-2 INTERPRETED SECTION



Note that the elevations for this section need to be checked against the project datum



apex geoservices

6 Knockmullen Business Park, Regus House, Herald Way
Co. Wickford
Ireland.
T +353 (0)402-21842
T +353 (0)402-21843
E info@apexgeoservices.ie
www.apexgeoservices.ie

PROJECT: GREATER DUBLIN REGIONAL DRAINAGE GEOPHYSICAL SURVEY
CLIENT: CAUSEWAY GEOTECH LTD.
DRAWING NO: AGL15015_03 GEO-2 RESULTS
SCALE: 1:750 @ A3
DATE: 13.02.15

Version	Date	Drawn By	Checked
1	13.02.15	SOR	TL

FIGURE 1: GEO-3 LOCATION

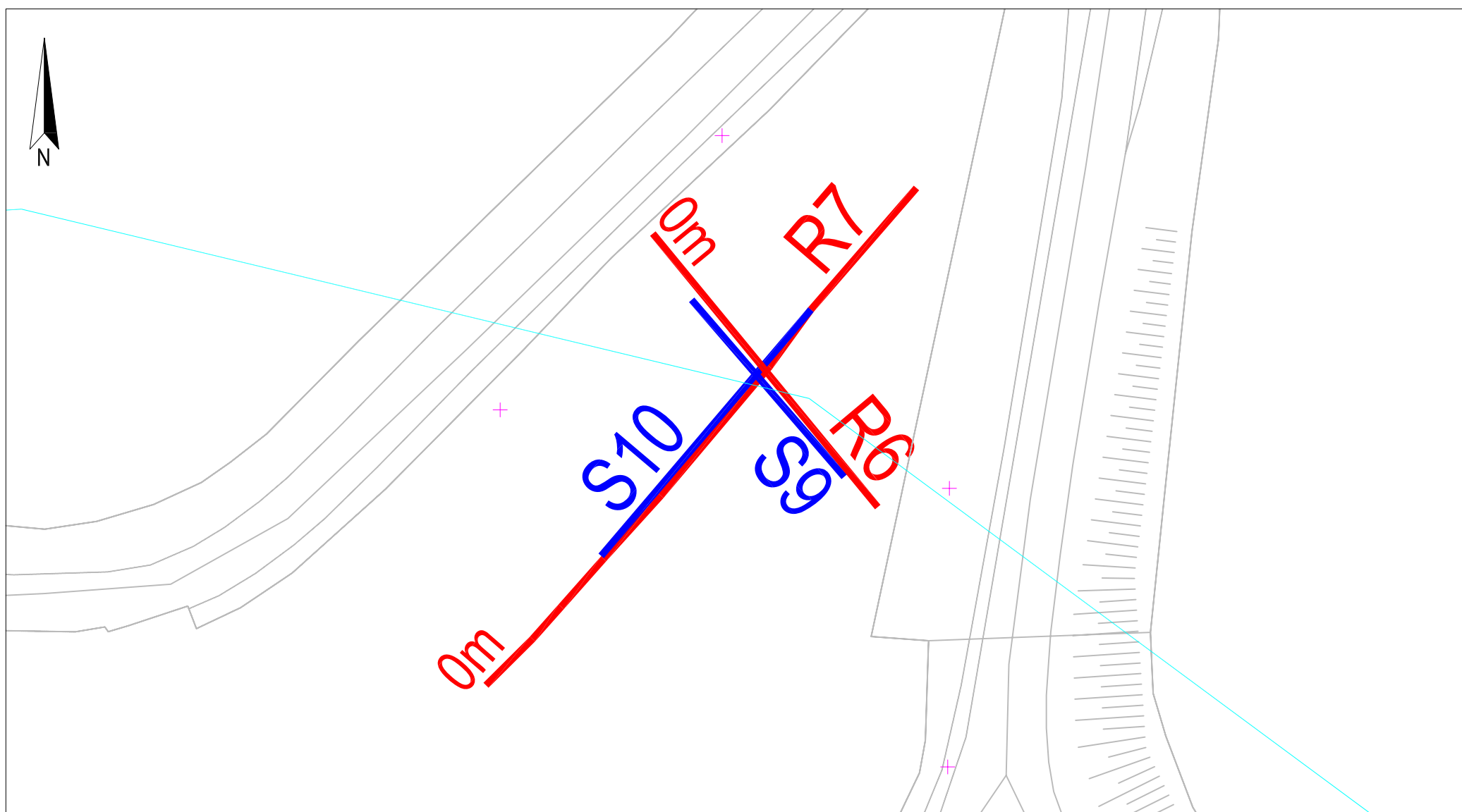
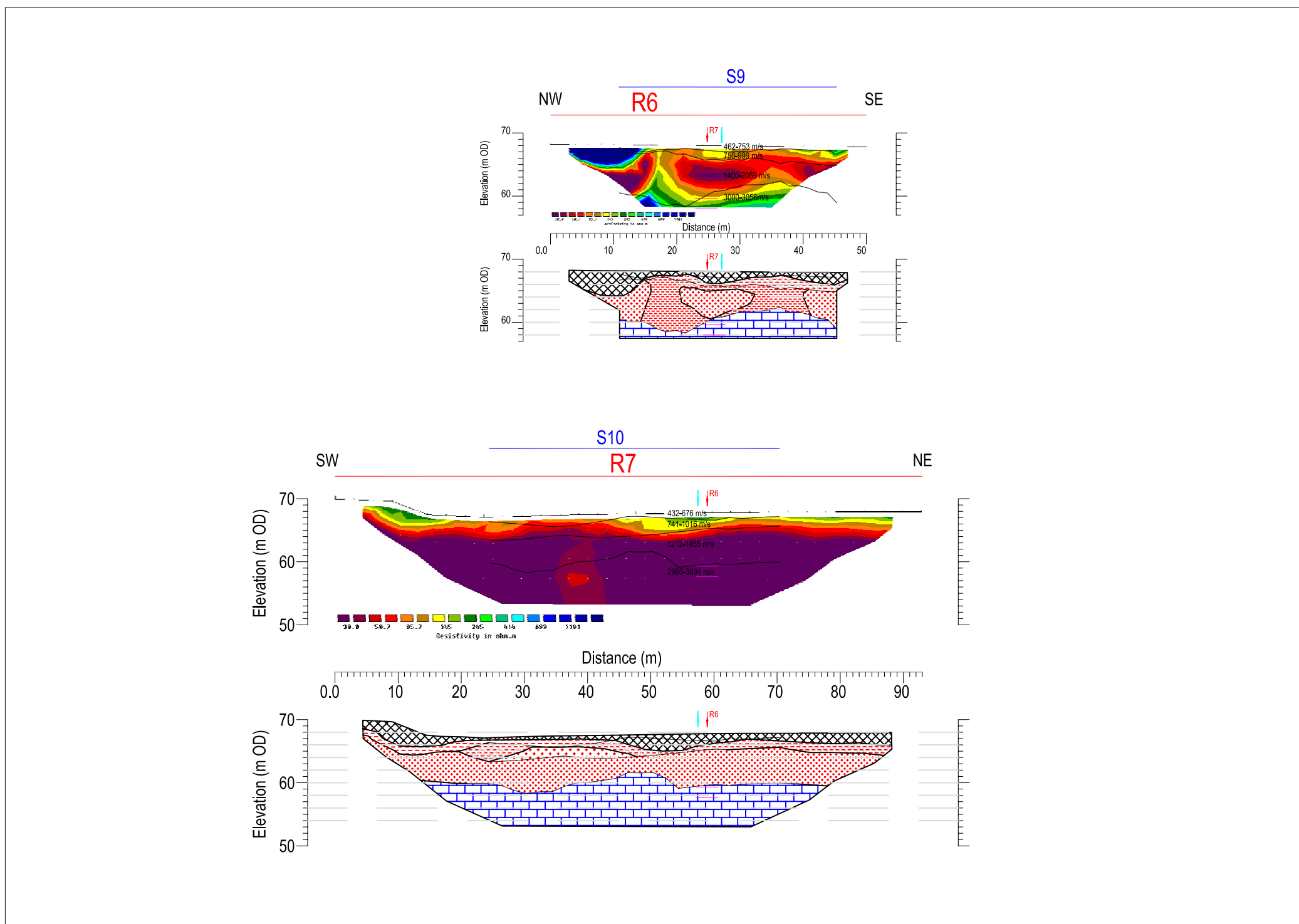

FIGURE 2: GEO-3 INTERPRETED SECTIONS



apex
geoservices

6 Knockmullen Business Park
Gorey
Co. Wexford
Ireland.
T +353 (0)402-21842
F +353 (0)402-21843
E info@apexgeoservices.ie
www.apexgeoservices.ie

Regus House, Herald Way
Pegasus Business Park
Castle Donington
Derby DE74 2TZ
UK
T +44 (0)844 8700 692
E info@apexgeoservices.co.uk
www.apexgeoservices.co.uk

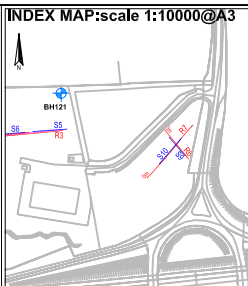

LEGEND:

- Made Ground
- Firm-Stiff SILT/CLAY
- Stiff-very Stiff SILT/CLAY
- Soft-Firm Sandy Gravelly CLAY
- Firm-Stiff Sandy Gravelly CLAY
- Stiff-very Stiff Sandy Gravelly CLAY
- Highly-Moderately Weathered Muddy LIMESTONE & SHALE
- Slightly Weathered-Fresh Muddy LIMESTONE & SHALE
- Proposed Pipeline Location
- Proposed Invert Level

PROJECT: GREATER DUBLIN REGIONAL DRAINAGE GEOPHYSICAL SURVEY			
CLIENT: CAUSEWAY GEOTECH LTD.			
DRAWING NO: AGL15015_04 GEO-3 RESULTS			
SCALE: 1:750 @ A3			
DATE: 13.02.15			
Version:	Date:	Drawn By:	Checked:
1	13.02.15	SOR	TL

Page left intentionally blank

Appendix A18.2 Ground Investigation Location Drawings